

CAMP DIGITAL

CAMP DIGITAL'S THUNDERBOLT HD MULTI-FORMAT PRODUCTION TRUCK

CAMERAS

Sony HDC1500L with Fiber Backs (wired for 12)
1 Iconix HD POV Camera with RCP160 remote controller
SONY RCP750 Remote Camera Controllers
Sony MSU 950 Master Set Up Unit
Sony CNU 700 Camera Control Network Hub
2 Leader LV5750 Scopes w/ Waveform and Vector
4 Sony 7" HD Color Studio Viewfinders
1 Fujinon 88x HD Studio Lens with Sony Sled
2 Fujinon 66x HD Studio Lens with Sony Sled
3 Fujinon 13 X 4.5
1 Fujinon 20X7.8
1 Fujinon 22x7.8
4 Sony Sleds for large lenses w/ 4 Sony 7" HD Color Studio Viewfinders
8000' Mohawk SMPTE Hybrid Fiber/Limo Connectors
Vector 70 and 75 Heads sticks for large lenses; Vinten Vision 250's; Vinten Vision 100's

SWITCHER

ROSS Vision QDM Switcher

- 24 Crosspoint Buttons on Panel
- 3 Multi-Level Effects Systems (MLE) Control Areas
- Auto-Follow, Industrial Grade, Dual Display System Control
- USB Ports for Keyboard, Mouse, and Media Drives
- 24 Custom Control Macro Buttons with 12 Way Shift
- On-Panel Aux Bus Control
- Source Awareness™ Automatic Features
- Unique Ross "Roll Clip" Button in Every MLE
- 100 Event Memory System
- Preview Overlay™ Safe Area/Title and Operator Heads-Up Information Display

GRAPHICS

ROSS Xpression 3D HD
Fully Loaded Package Including Features of Designer, Player and BlueBox

- 3 RU Rackmount Chassis with Current Ross HW specification,
- Support for 2 Video Output Channels , Each with Video+Key
- Support for 2 Video Input Channels
- Support for Multiple Virtual Preview Channels
- Support for Multiple Virtual Channels
- Real-time 2D/3D Graphics Engine
- Template Designer
- Template Playout Sequencer
- .Net based scripting
- High Definition Formats (HD)
- Standard Definition Formats (SD)
- TrueD! Anaglyphic Preview
- Simultaneous Multi Definition Output
- Real-time Up, Down and Aspect Ratio Conversion
- Custom Resolution Video Formats
- Video Clips and Dynamic Textures
- Graphical Keyframe Editor

- Framebuffer Layers
- Scene Director
- Continuous Animations
- Render To Disk
- XPression Video Coder
- Project Video Format Conversion
- Live Input Shader (DVE/Keying)
- Webcam Input (DirectShow) Support
- PowerPoint Shader
- Window Capture Shader
- 2D / 3D Font Engine
- Multi Language Support

AUDIO

Soundcraft Vi4 96 Channel Digital Audio Console + Soundcraft Vi1 64 Channel Digital Audio Console – Built on the Studer platform, the Soundcraft consoles include Vistonics mapping, 3rd octave graphic EQ, 8 independent stereo Lexicon multi-effects units including 14 reverbs, 7 delays, and 8 pitch-shifting effects. Dynamic section controls with noise gates, full function compressors, and independent limiters on each channel.

JBL LSR4326 Monitors

128 Input Remote Stage Box

Protools 128 channels via SSL Delta Link

2 64 track Joeco Digital Multi-track Recorders (Back-up)

Direct Out M.1K2 512x512 MADI Router

Alesis ML9600 High Resolution Master Disk Recorder

TC Electronics Finalizer Express

Apogee Big Ben Master Digital Clock

Logitec Analog VU Meters with Phase Test

Analog, Digital or MADI AES signal flow

HARD DISK VIDEO RECORDING / VIDEOTAPE

16 AJA KiPro Rack hard disk recorders with 500G hard drives

2 DVD Recorder/Players

6 Channel EVS XT2 with X-File

COMMUNICATION

RTS CRONUS Digital Matrix Comm, 32 port

14 KP-12LK Talk/Listen Panels

2 MKP-45P Talk Listen Terminals

3 Dual Digital Interface 2W-4W

RTS PS31 and PS15 Power Supplies

6 Additional Channels Wet PL at I/O panel

6 Channels of 2 Wire at I/O Panel

4 Channels of IFB (wet or dry)

RTS 16 Channel SAP

2 RTS Telephone Interface

16 RTS BPM325 Belt Packs

4 RTS IFB Belt Packs with earpieces

16 Beyer Single Muff Headsets

10 Beyer Dual Muff Headsets

16 RTS PH-88R5 Lightweight Headsets

TERMINAL

ROSS 72x72 Digital Video Router
ROSS 32x32 AES Audio Router
ROSS 32x32 Analog Audio Router
Teranex 2D Standards Converter
2 AJA FS-1 Digital Frame Syncs
1 AJA FS-2 Digital Frame Sync
Ensemble Designs Digital DA
ESE HD/SDI Time Code Generator
Evertz VIP Multi Imager (includes 1 VIP4, 2 VIP8, and 1 VIP12)

INTERNAL MONITORING

4 Sony 42" LCD Display (Production Monitor Wall)
3 Sony LMD 2110 22" Preview/Program Monitors (Production Wall)
36 BlackMagic Designs Smartview Duo 8" Monitors (throughout truck)
4 Sony 17" OLED Reference Monitors with built-in scope (Video Shading and Lighting Director positions)
2 Black Magic Smartview 17" LCD HD Monitor (EVS Position)
1 Sony 17" LCD HD Reference Monitor (Tape Position)
1 Samsung 32" LED Program Monitor (Audio Room)
3 Marshall 7" Dual HD monitors
3 23" LCD HD Monitors in Audio
2 22" LCD HD Monitor in Audio
1 16" LCD HD Program Monitor

AUDIO MICS

4 Sony ECM-77Bs
6 Sony ECM 673s
4 Audio-Technica 5100s
4 Audio-Technica 4150s
3 AKG 451s with E or C Capsules
5 Audio-Technica 4033s
2 Audio-Technica 4050s

EXTERNAL MONITORS

1 Sony 40" LCD Bravia
1 Sony 32" LCD Bravia
2 Sony 17" LCD Reference Monitors
2 Sony 15" LCD Reference Monitors
1 23" LCD flatscreen w/ AJA HD/SDI to HDMI Converter
1 21" LCD flatscreen w/ AJA HD/SDI to HDMI Converters
Various Analog throw down monitors

MISCELLANEOUS

1000' TAC 12 Single Mode Fiber
2 500' TAC 4 Single Mode Fiber
300' TAC 4 Single Mode Fiber
8 Sets AJA Fido BNC/Fiber Converters
6 AJA Hi5 SDI – HDMI Converters
3 AJA SDI DA's
4 Black Magic SDI – HDMI Converters
2 Black Magic SDI – Analog Converters
2 Black Magic Analog – SDI Converters
2 Sets Fiber – Cat5 – Fiber Converters

POWER REQUIREMENTS

208 Volt / 200 Amp Single Phase
100' feeder cable

DIMENSIONS

Trailer Length 42'6" / 54' with Tow Vehicle
Trailer Width Expanded 18' (8'6" for travel)
Height 13'4"

THUNDERBOLT HD PRODUCTION MONITOR WALL

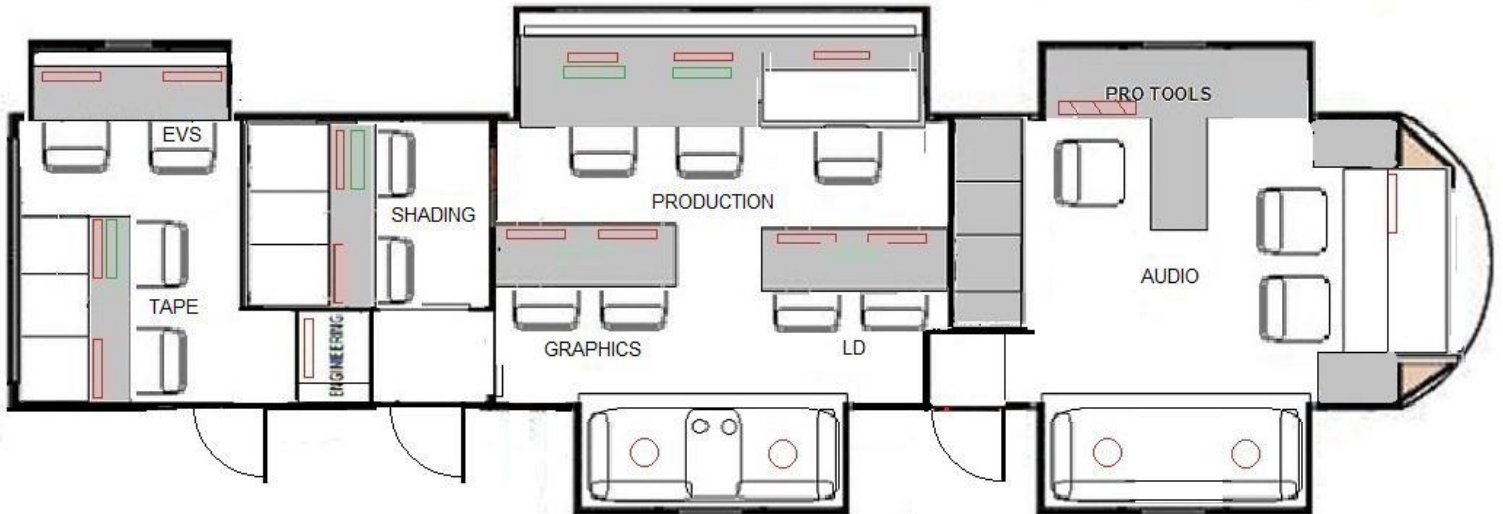
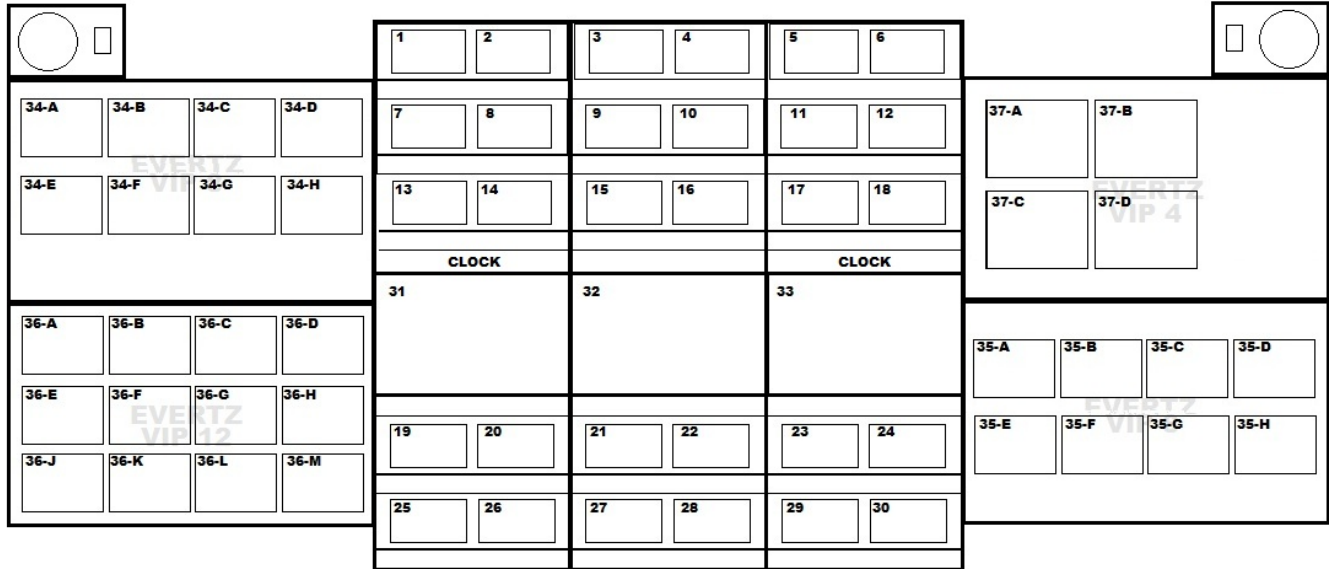

AUDIO STAGEBOX

MAIN



BACKUP

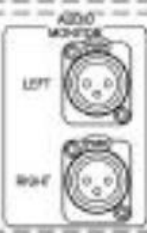
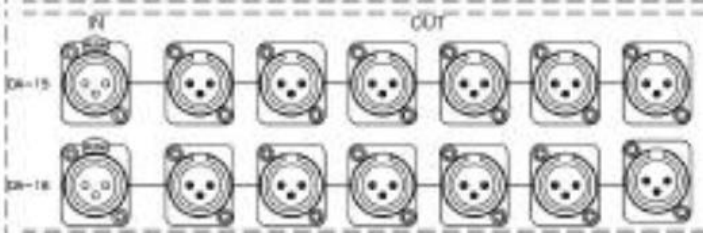

AUX TIE LINES



AUDIO TIE LINES

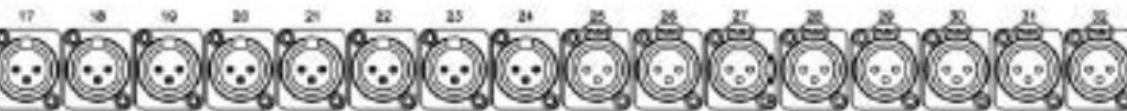

PROGRAM AUDIO

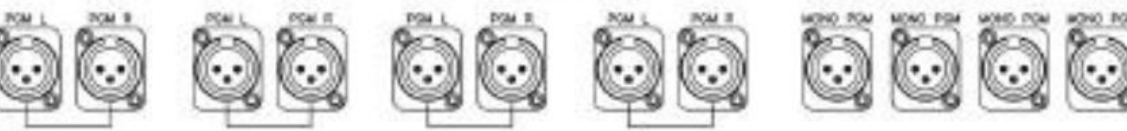

SAP OUT

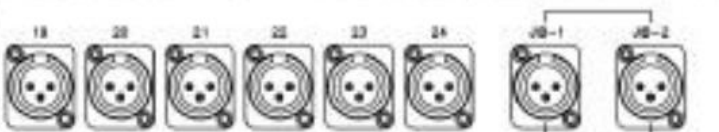

FB



WEST

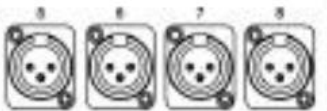

EAST

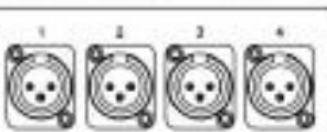

MM



